

CARRIER TOP CASE ›AMSTERDAM BOX L‹

Art. 122460 / 122470

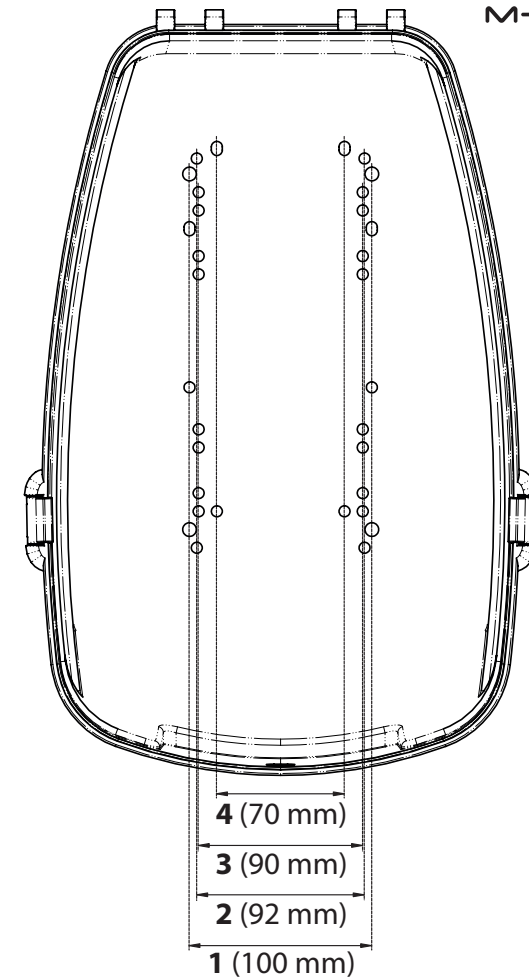
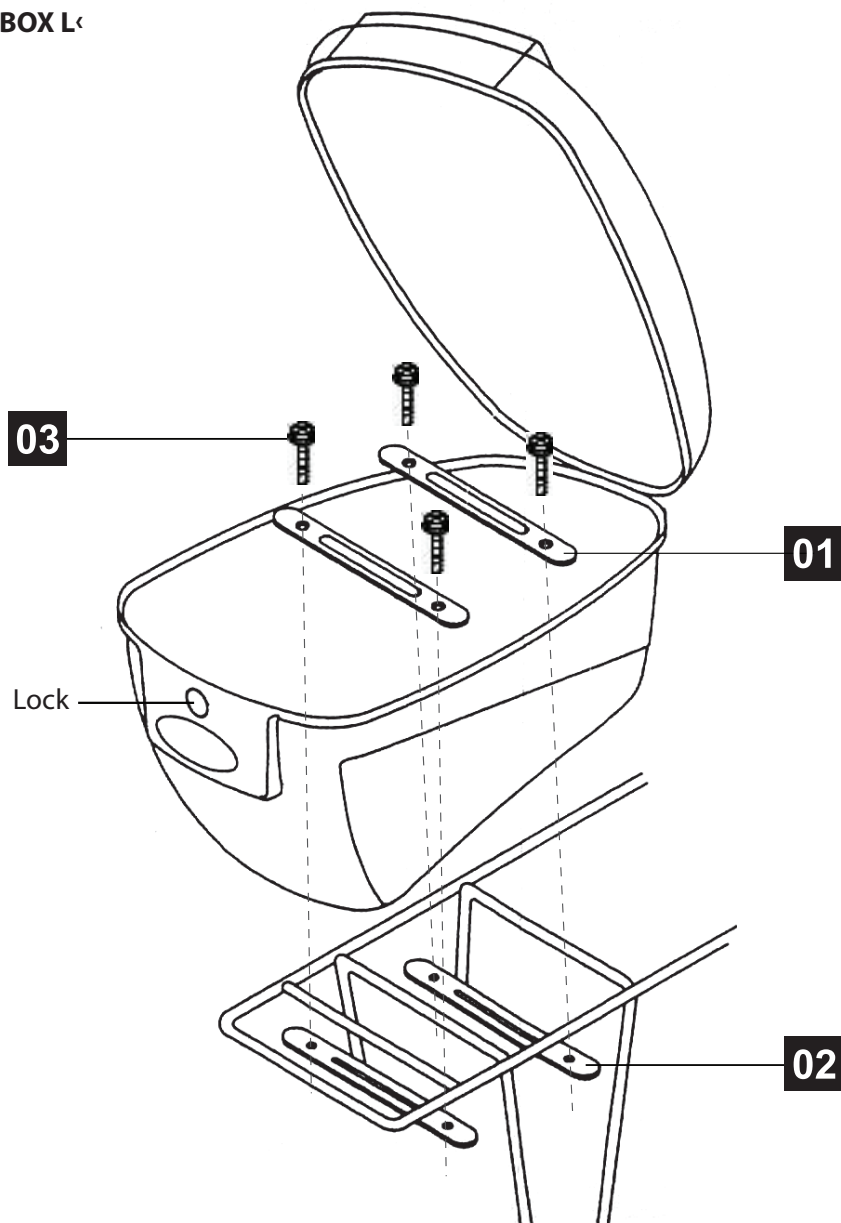
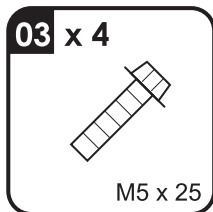
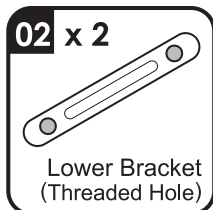
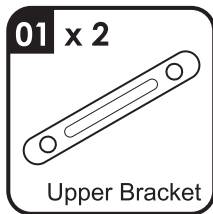

1
SW-NKC-003
MIK
Racktime
KLICKfix
AtranVelo
M-Wave Art. 122460/70

2
M-Wave Art. 122495
SW-CR-111
3
SW-CR-113
4
AUTHOR
XLC

⚠
Ensure secure and tight mounting and check the screws regularly. The maximum load of the box must not exceed the maximum load of the respective carrier.
Stellen Sie eine sichere und feste Montage sicher und überprüfen Sie die Schrauben regelmäßig. Die maximale Beladung der Box darf die max. Belastung des jeweiligen Gepäckträgers nicht überschreiten.
Keep for future reference!
Anleitung sorgfältig aufbewahren!

distributed by:
messingschlag
Messingschlag GmbH & Co. KG
Hassbergstr. 45
96148 Baunach - Germany
www.messingschlag.com



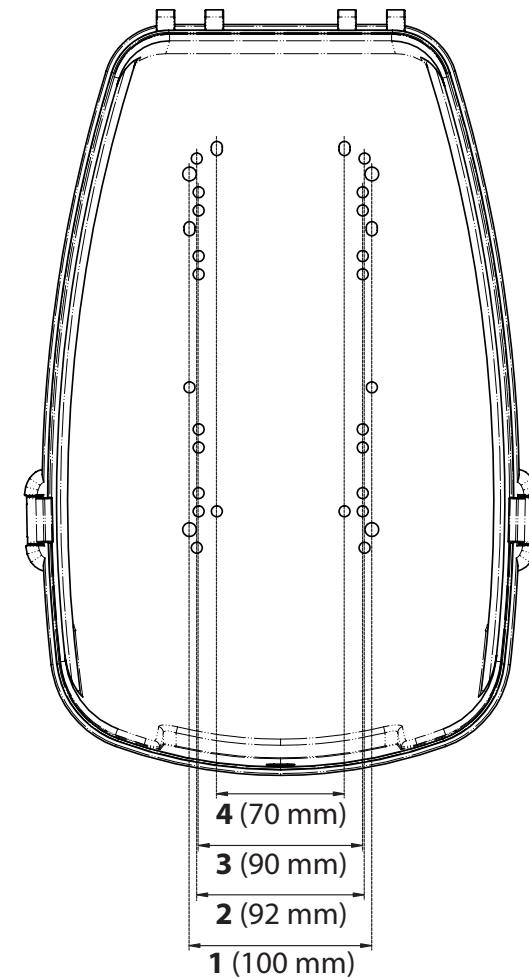
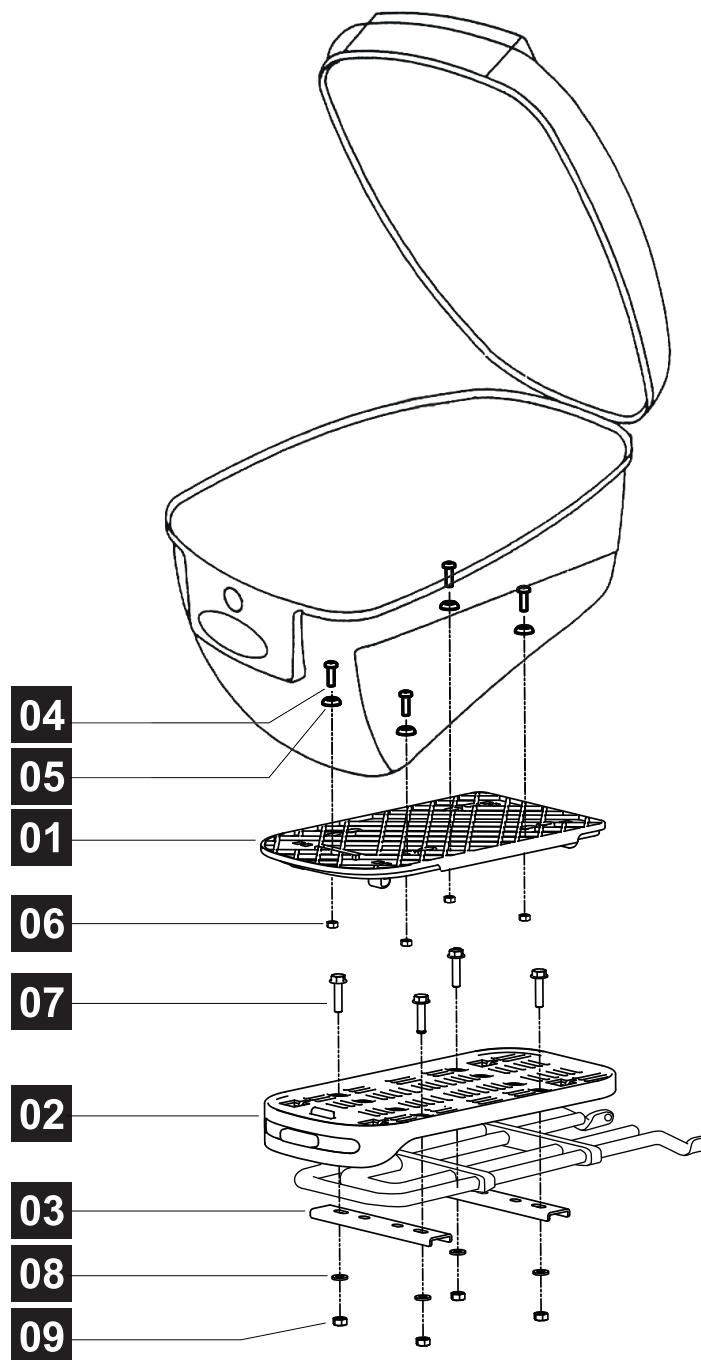
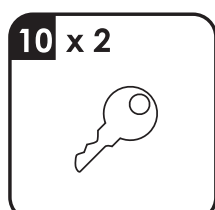
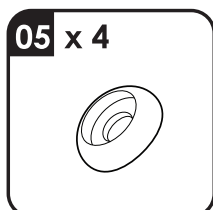
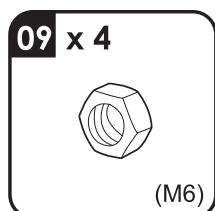
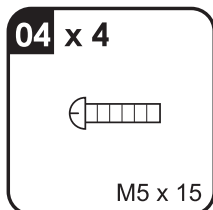
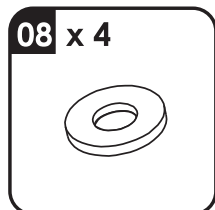
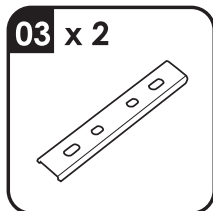
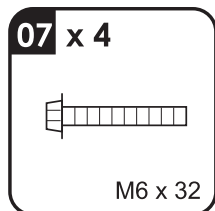
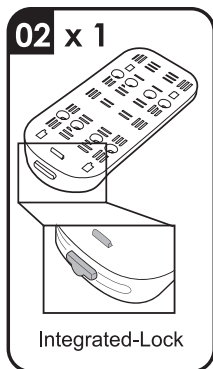
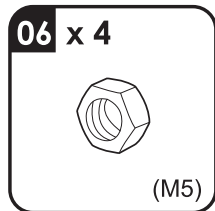
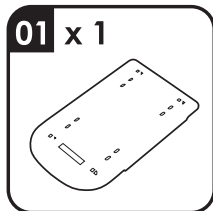

1
 SW-NKC-003
 MIK
 Racktime
 KLICKfix
 AtranVelo
 M-Wave Art. 122460/70

2
 M-Wave Art. 122495
 SW-CR-111

3
 SW-CR-113

4
 AUTHOR
 XLC